

Architect

Cycle Architecture
29 West 17th Street, 4th Floor
New York, New York 10011
p. 212.227.2811
f. 646.983.2455

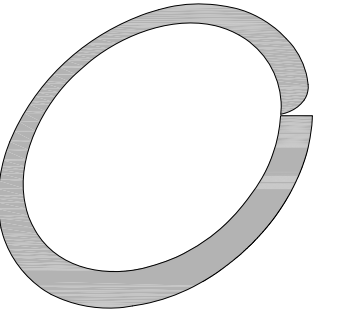

cyclearchitecture

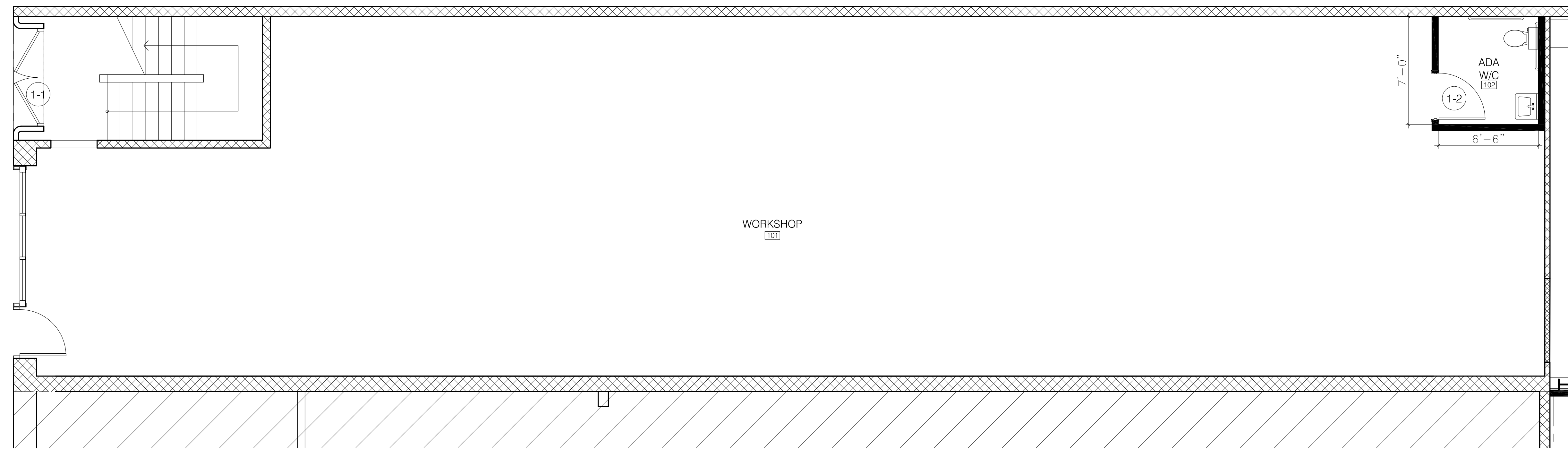

1 GROUND FLOOR PLAN
1/4" = 1'-0"

LEGEND	
	NEW CMU WALL
	EXISTING WALL
	EXISTING PARTITION
	PARTITION TYPE
	NEW PARTITION
	NEW 2HR RATED PARTITION
	EXISTING DOOR
	NEW DOOR AND DOOR TAG
	BUILDING SECTION TAG
	SECTION DETAIL TAG
	EXIT SIGN
	AREA NOT IN SCOPE
	AREA OF WORK
	AREA OF DETAIL
	DRAWING TAG

POWER LEGEND	
	20 AMP, 220 VOLT OUTLET
	DUPLEX
	DEDICATED DUPLEX OR QUADPLEX
	DUPLEX EXPOSED TYPE GALVANIZED
	QUAD PLEX
	GFI DUPLEX
	GFI QUAD
	NEW ELECTRICAL SUB PANEL
	VOICE JACK
	DATA JACK
	VOICE/DATA JACK
	EXG OUTLET
	EXG QUAD OUTLET
	EXG GFI DUPLEX
	EXG VOICE JACK
	EXG DATA JACK
	SUBWOOFER
	CABLE JACK
	EXG CABLE JACK
	HARD-WIRED SMOKE DETECTOR
	DUPLEX FOR OUTDOOR
	MILLWORK / FURNITURE

This drawing is an instrument of service furnished by Cycle Architecture PLLC who holds its copyright. This drawing may not be used or reproduced for this or any other project or purpose without the express permission of Cycle Architecture PLLC. This drawing and any copies of it shall remain the property of Cycle Architecture PLLC. All rights reserved. c. 2010, 2011, 2012, 2013.

The intent of this drawing is to illustrate the general concepts of spatial design in terms of layout, dimensions, finishes & equipment. Any structural, mechanical or electrical work indicated or implied herein, must conform to and be coordinated with local Building Department approved drawings and must comply with all codes and laws of regulatory agencies having jurisdiction thereof.

Do NOT scale this drawing to determine any measurements for work shown. Use dimensions specified or verify with project architect if dimensions are not specified or are unclear.

REVISIONS

TAG	REVISION	DATE

SHEET TITLE:

PARTIAL
GROUND FLOOR PLAN

SCALE AS NOTED

DATE 11.19.18

DRAWN BY STAFF

CYCLE PROJECT NUMBER

SHEET NUMBER:

A-102.00

PRELIMINARY